

Installation Guide

SPK100, SPK502

Wall mount for the SpacePole Kiosk

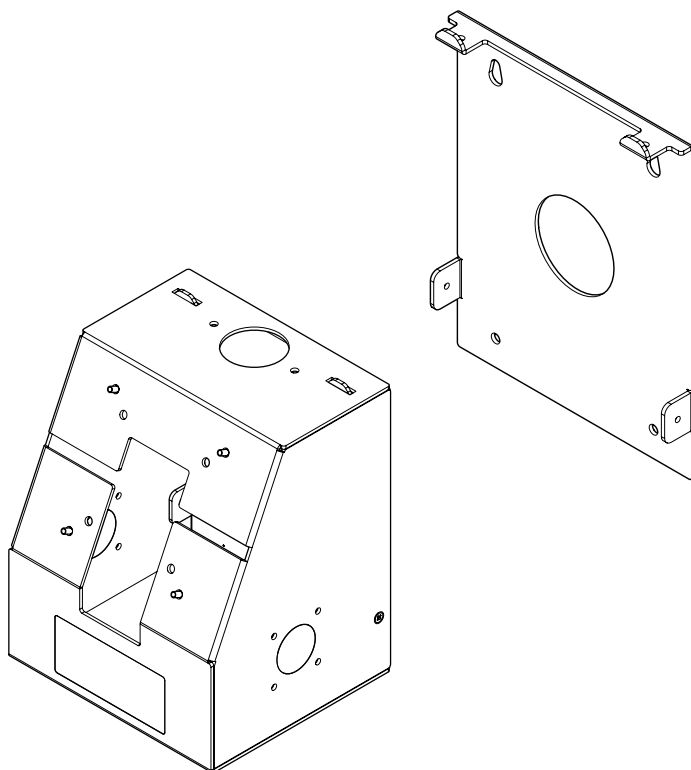

Box Content

SPK502

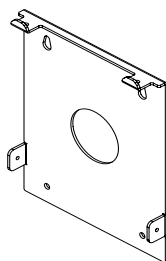

x1

SPK100

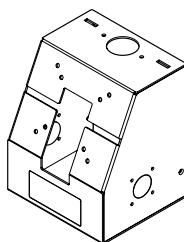

x 1

 x4 M4x8

 x2 M4x8 countersunk

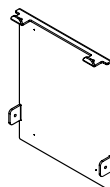

x1

Wall fixings not included



It is the responsibility of the installers to ensure the correct fixings are used for the specific type of wall as well as ensuring the wall is stable enough to carry the weight of the solution

1 Fix top screws, place wall bracket and secure

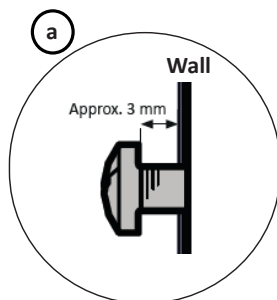

a

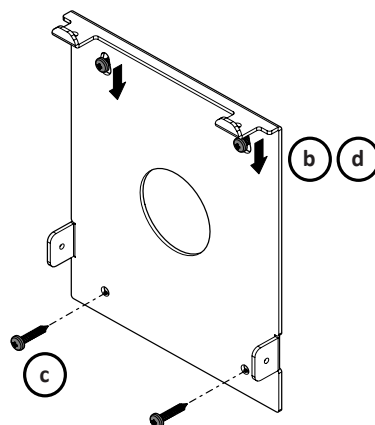

a

Fix top screws

b

Place wall bracket

c

Fix bottom screws

d

Fasten top screws

2 Install screen

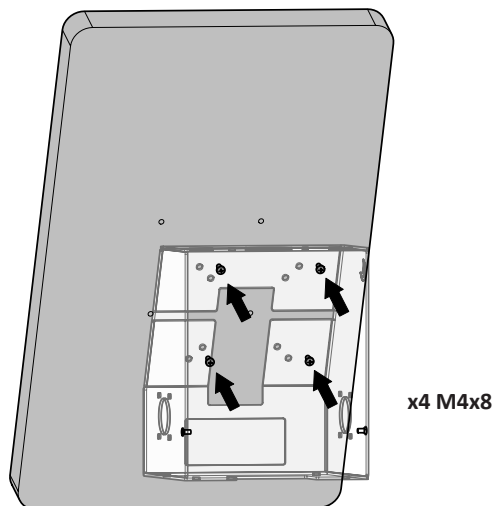

3 Run cables

Two options for cable management

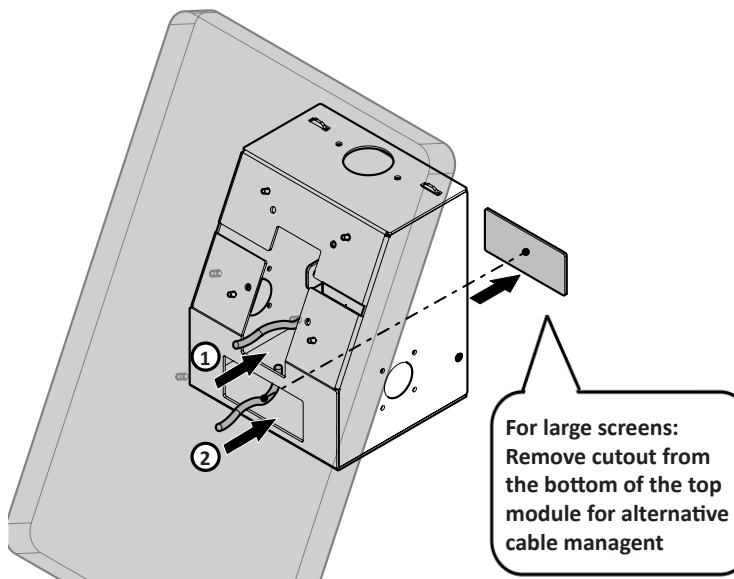

4 Hang kiosk on the wall mount

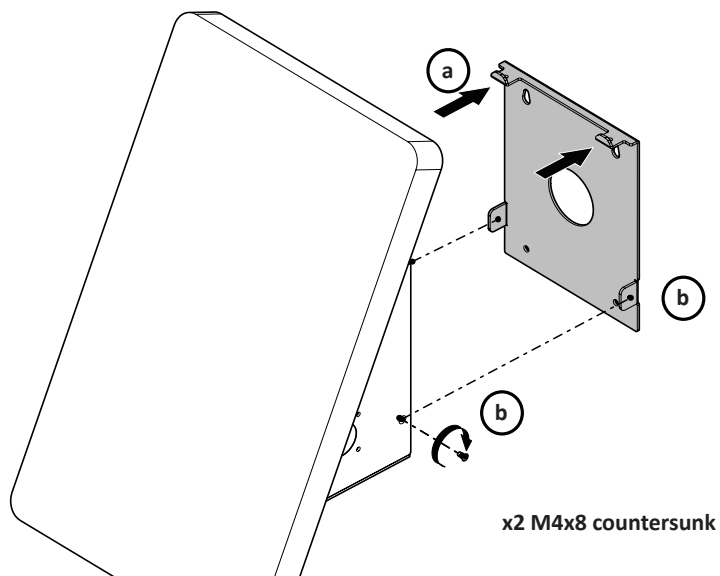

With center module (optional)

5 Secure to wall with appropriate fixings

